

MB NC Threaded Inserts

(6650) PC-11 THREADED INSERT - PLASTIC

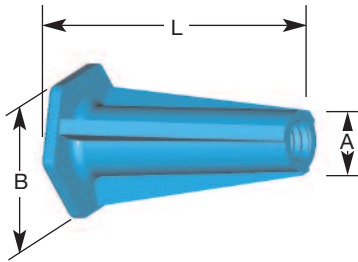

MB Item #	Bolt Size	Dim. A	Dim. B	Dim. L	Safe Work Load	Pieces Per Package	Weight Per Package
283096	3/8"	3/4"	1"	1-1/2"	1,300	1,000	18
283097	1/2"	3/4"	1-3/8"	2-5/8"	3,000	500	32
283099	3/4"	1"	1-5/8"	3-1/4"	4,300	200	15

To Order, Specify: quantity, name and item number.

(6655) MX-3 HI-TENSILE INSERT - Ductile Iron

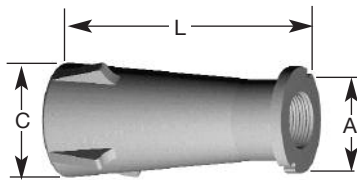

MB Item #	Bolt Size	Dim. A	Dim. L	Dim. C	Description	Weight Per 100 (lbs)
270100	1/4"	1-1/8"	1-5/8"	5/8"	1/4" x 1-5/8"	13
279102	3/8"	1-1/8"	1-5/8"	1"	3/8" x 1-5/8"	25
279104	1/2"	1-1/4"	2-1/4"	1-3/8"	1/2" x 2-3/4"	31
279106	5/8"	1-3/8"	2-3/4"	1-1/2"	5/8" x 2-3/4"	50
279108	3/4"	1-1/2"	3-3/8"	1-5/8"	3/4" x 3-3/8"	69
279110	7/8"	1-5/8"	4"	1-3/4"	7/8" x 4"	94
279112	1"	1-3/4"	4-1/2"	1-7/8"	1" x 4-1/2"	106

To Order, Specify: quantity, name and item number.

(6660) MX-5 "Y" INSERT - Ductile Iron

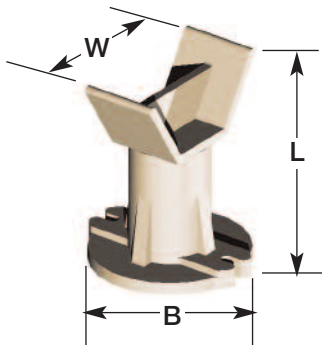

MB Item #	Thread Diameter	Safe Work Load (lbs)	Dim. L	Dim. W	Dim. B
600400	3/8"	750	2"	1-9/16"	1-3/8"
600442	1/2"	1,500	2-1/8"	1-3/4"	1-3/4"
600484	5/8"	2,000	2-1/2"	2"	1-7/8"
600523	3/4"	2,500	2-11/16"	2-1/4"	1-7/8"
600565	7/8"	3,000	3-3/8"	2-15/16"	2-1/8"
600691	1"	3,000	3-3/8"	2-15/16"	2-1/8"

To Order, Specify: quantity, name and item number.

General Line Products

MB NC Threaded Inserts

(6665) FX-51 FERRULE INSERT - OPEN

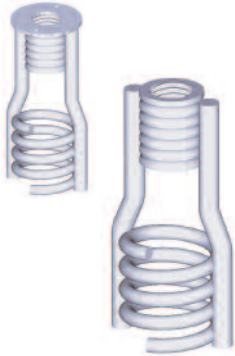

MB Item #	Description		Safe Work Load	Wire Diameter	Weight Per 100 (lbs)
	Size	Struts			
432720	3/4" x 4-1/2"	2	4,250	0.375	60
432733	1" x 5-1/2"	2	6,250	0.440	115
432739	1" x 7-1/2"	4	10,000	0.440	215
432745	1-1/4" x 7-1/2"	4	12,000	0.440	240
432751	1-1/4" x 9-1/2"	6	16,000	0.440	390
432757	1-1/2" x 9-1/2"	6	16,000	0.440	420

Safety factor is approximately 4:1.

N.C. threaded ferrule for structural connections.

Ferrule may be fitted with a mounting washer if required.

NOTE: For Finish - Specify "Plain", "Electro-Plated" (E.Plated), "Hot Dip Galvanized" (HDG)

To Order, Specify: quantity, name and item number.

184

(6670) FS-2 FERRULE INSERT - STANDARD

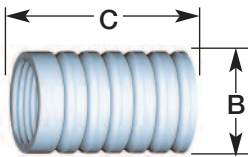

MB Item # Plain	MB Item # E. Plated	Bolt Diameter	B	C	Wire Diameter
431835	201841	3/8"	9/16"	1-1/4"	5
431841	201870	1/2"	11/16"	1-3/8"	7.5
431845	201906	5/8"	7/8"	1-5/8"	15
431851	201935	3/4"	1"	1-5/8"	17.5
431855	201964	7/8"	1-1/4"	1-5/8"	45
431861	201974	1"	1-3/8"	1-5/8"	37.5

Safety factor is approximately 3:1.

Set-up charge on Galvanized orders under 350 lbs.

NOTE: For Finish - Specify "Plain", "Electro-Plated" (E.Plated), "Hot Dip Galvanized" (HDG)

To Order, Specify: quantity, name, item number and finish.

MB NC Threaded Inserts

(6675) FX-2 FERRULE INSERT - STRAIGHT LOOP

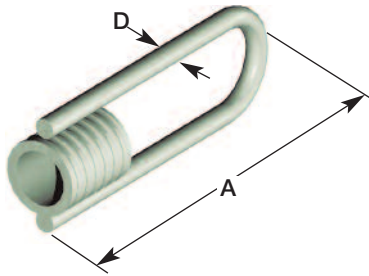

MB Item # Plain	MB Item # E. Plated	Description		Wire Diameter D	Safe Work Load	Weight Per 100 (lbs)
		Size	A			
431899	431909	1/2" x 4"	4-1/8"	0.225	3,000	25
431912	431925	1/2" x 6"	6-1/8"	0.306	4,000	38
431938	431941	5/8" x 4"	4-1/8"	0.225	3,000	35
431954	431967	5/8" x 6"	6-1/8"	0.375	5,000	48
431970	431983	3/4" x 4"	4-1/8"	0.255	3,000	54
431996	432005	3/4" x 6"	6-1/8"	0.375	5,000	67
432008	432011	7/8" x 6"	6-1/8"	0.375	5,000	75
432018	432021	1" x 6"	6-1/8"	0.375	5,000	75
432034	432047	1" x 8"	8-1/8"	0.375	5,000	103

Safety factor is approximately 3:1.

Set-up charge for orders less than 200 pieces per size.

Set-up charge on Galvanized orders under 350 lbs.

NOTE: For Finish - Specify "Plain", "Electro-Plated" (E.Plated), "Hot Dip Galvanized" (HDG)

To Order, Specify: quantity, name, item number and finish.

185

(6680) FX-5 FERRULE INSERT - LOOP

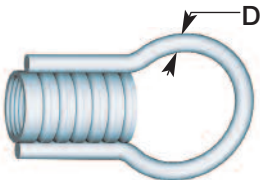

MB Item # Plain	MB Item # E. Plated	Description		Wire Diameter D	Safe Work Load	Weight Per 100 (lbs)
		Size				
430528	430531	3/8" x 2-3/4"		0.243	2,000	14
430544	430557	1/2" x 2-3/4"		0.243	2,000	21
430560	430573	5/8" x 3-1/2"		0.262	2,300	34
430586	430599	3/4" x 3-1/2"		0.262	2,400	38
430601	430608	7/8" x 6"		0.375	5,300	62
430609	430612	1" x 6"		0.375	5,300	57

Safety factor is approximately 3:1.

Set-up charge on Galvanized orders under 350 lbs.

NOTE: For Finish - Specify "Plain", "Electro-Plated" (E.Plated), "Hot Dip Galvanized" (HDG)

To Order, Specify: quantity, name, item number and finish.

General Line Products

MB NC Threaded Inserts

(6685) FX-14 FERRULE INSERT - THIN SLAB

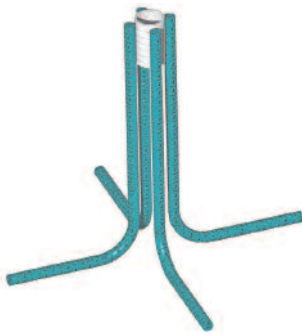

MB Item # Plain	MB Item # E. Plated	Thread Diameter	Safe Work Load	Weight Per 100 (lbs)
430829	430816	3/4"	3,500	71
430832	430845	1"	4,500	99

Safety factor is approximately 3:1.

Set-up charge on Galvanized orders under 350 lbs.

NOTE: For Finish - Specify "Plain", "Electro-Plated" (E.Plated), "Hot Dip Galvanized" (HDG)

To Order, Specify: quantity, name, item number and finish.

(6690) FX-16 FERRULE INSERT - THIN SLAB STRUT

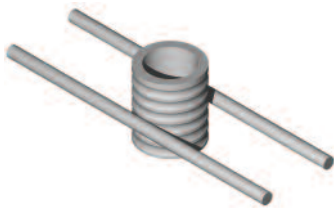

MB Item # Plain	MB Item # E. Plated	Description	Wire Diameter D	Safe Work Load (lbs)	Weight Per 100 (lbs)
		Size			
430625	430638	3/4" x 4"	0.262	450	18
430641	430654	1/2" x 4"	0.262	900	20
430667	430670	5/8" x 4"	0.262	1,000	28
430683	430696	3/4" x 4"	0.262	1,600	31
430701	430704	7/8" x 4"	0.262	1,600	59
430697	430698	1" x 4"	0.262	1,600	51

Safety factor is approximately 3:1.

Set-up charge on Galvanized orders under 350 lbs.

NOTE: For Finish - Specify "Plain", "Electro-Plated" (E.Plated), "Hot Dip Galvanized" (HDG)

To Order, Specify: quantity, name, item number and finish.

(6695) FX-19 FERRULE INSERT - WING



MB Item # Plain	MB Item # E. Plated	Description	Wire Diameter D	Safe Work Load (lbs)	Weight Per 100 (lbs)
		Size - Height - Width			
430748	430780	1/2" x 1-5/8" x 4-1/2"	0.225	1,200	25
430750	430783	5/8" x 2-3/8" x 4-3/4"	0.306	2,500	45
430751	430793	3/4" x 2-3/8" x 4-7/8"	0.306	2,650	48
430754	430796	3/4" x 3-1/2" x 4-7/8"	0.306	4,500	67
430764	430803	1" x 3-1/2" x 5-1/8"	0.375	4,500	85
430767	430806	1" x 4-1/2" x 5-1/8"	0.375	6,500	107

Safety factor is approximately 3:1.

Set-up charge on Galvanized orders under 350 lbs.

NOTE: For Finish - Specify "Plain", "Electro-Plated" (E.Plated), "Hot Dip Galvanized" (HDG)

To Order, Specify: quantity, name, item number and finish.

MB NC Threaded Inserts

(6700) MX-25 PRECAST CONCRETE INSERT - METAL

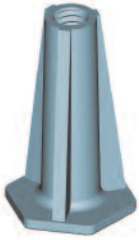

MB Item # Plain	MB Item # E. Plated	Bolt Size	Length	Safe Work Load (lbs)
201819	P15T	1/4" - 20	1-1/2"	575
201821	P24T	3/8" - 16	1"	1,025
201823	P25T	3/8" - 16	1-3/8"	1,200
201825	P35T	1/2" - 13	1-1/2"	1,225
201827	P36T	1/2" - 13	2-7/8"	2,025
201829	P45T	5/8" - 11	1-11/16"	1,575
201831	P46T	5/8" - 11	2-7/8"	2,500
201833	P55T	3/4" - 10	1-11/16"	1,725
201835	P56T	3/4" - 10	3"	3,125

Safety factor is approximately 3:1.

To Order, Specify: quantity, name and item number.

(6750) MX-28 METAL NC THREAD



MB Item #	Bolt Size	Weight Per 100 (lbs)
201803	3/8"	1.54
201805	1/2"	3.8
201807	5/8"	8.4
201809	3/4"	11.84

To Order, Specify: quantity, name and diameter.

(6755) FC-18 PLASTIC NC THREAD



MB Item #	Bolt Size	Weight Per 100 (lbs)
201677	3/8"	0.5
201678	1/2"	0.7
201679	5/8"	0.9
201680	3/4"	1
201683	7/8"	1.1
201686	1"	1.2

To Order, Specify: quantity, name and diameter.

General Line Products

MB NC Threaded Inserts

(6760) FC-17 PLASTIC FERRULE



MB Item #	Size	Weight Per 100 (lbs)
201595	3/8"	0.2
201605	1/2"	0.2
201621	5/8"	0.3
201647	3/4"	0.4
201648	7/8"	0.7
201663	1"	0.8
201676	1-1/4"	1

To Order, Specify: quantity, name and diameter.

(2255) FC-19 THE HOLE PLUG

188



MB Item #	Size	Weight Per Carton (lbs)	Pieces Per Carton (lbs)
201690	9/16"	2.25	1,000
201694	13/16"	3.48	500

To Order, Specify: quantity, name and diameter.

(6780) RL-71 CHAIN GUARD

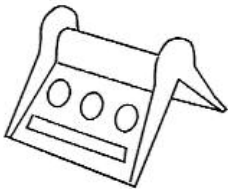

MB Item #	Size	Weight Per Carton (lbs)	Pieces Per Carton (lbs)
291534	1-3/4"	10	100
291535	4-1/4"	11	50

To Order, Specify: quantity, name.

(6789) FG-7 FORM GASKET

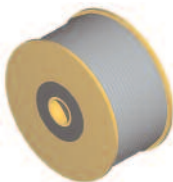

MB Item #	Description	Reels Per Package	Weight Per Package (lbs)
282920	1/4" x 3/8" x 1,000	4	14
282922	1/4" x 1/2" x 1,000	4	16
282924	1/2" x 1/2" x 660	4	16

To Order, Specify: quantity, name.